



JONES POTTS TAYLOR



80 Warwick Road

Atherton, Manchester, M46 9PW

Offers in excess of £150,000

JonesPottsTaylor are delighted to present FOR SALE this three bedroom semi-detached property, situated in a popular residential location in Atherton. The property briefly comprises of; entrance hallway, living room and kitchen leading to the rear garden. To the first floor are three well proportioned bedrooms and a further three piece bathroom suite. Outside to the front is a larger than average garden offering off road garden and detached garage. To the rear is an enclosed low maintenance garden.

Viewings for this property are a must, it offers a generous outside space and development growth.

Viewing

Please contact our Jones Potts Taylor Office on 01942 368600 if you wish to arrange a viewing appointment for this property or require further information.

- No Onward Chain
- Tenure Freehold
- Investment / Development Opportunity
- Corner Plot Location
- Gas Central Heating
- UPVC Double Glazing



D

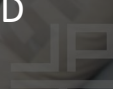

Floor Plan

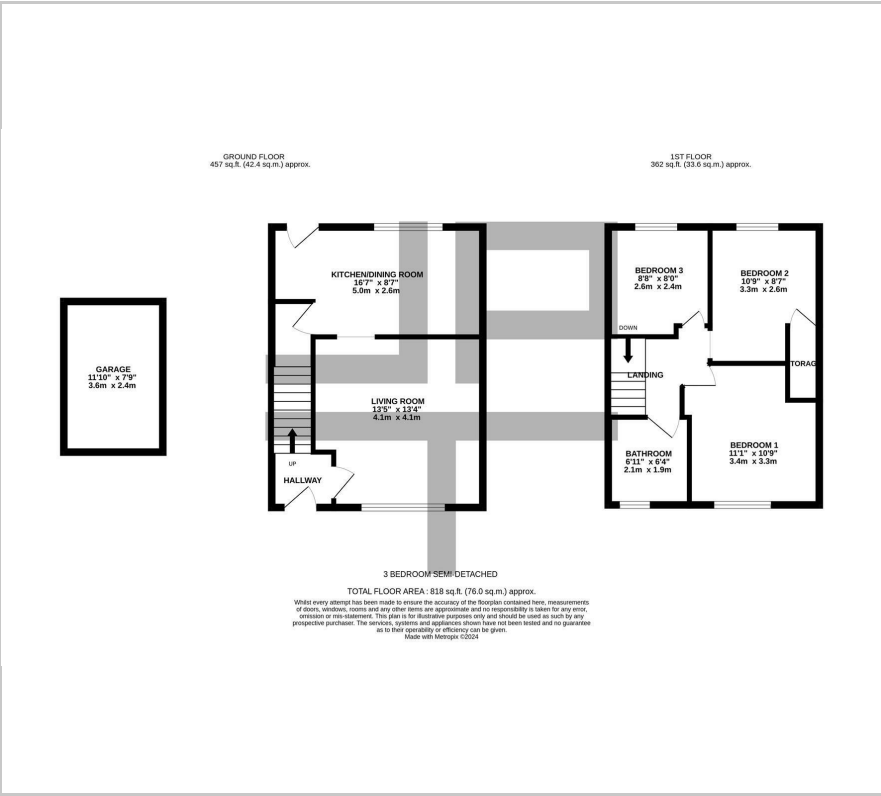

Area Map



Energy Efficiency Graph

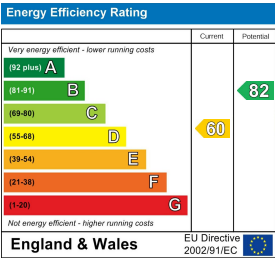

These particulars, whilst believed to be accurate are set out as a general outline only for guidance and do not constitute any part of an offer or contract. Intending purchasers should not rely on them as statements of representation of fact, but must satisfy themselves by inspection or otherwise as to their accuracy. No person in this firms employment has the authority to make or give any representation or warranty in respect of the property.